

Product manual

Solar connector

Type: PV-JM601/PV-JM601A/PV-J608 (PC/644Z/PV40Z)

Catalog

Product overview 1
 Safety instruction 2
 Chemical resistance 3
 Installation instruction 4-7
 Connect and disconnect 8

Product overview:

PV-JM601 solar connector, use inside the cylindrical plug reds, male female head with connector and cable, and female head inserted with self-locking mechanism, using electrical contact and connection is more reliable.

Main technical specifications:

- Rated voltage: 1000V DC
- Rated current: 25A
- Contact resistance: $\leq 0.5 \text{ m}\Omega$
- Operating temperature: $-40^{\circ}\text{C} \sim +85^{\circ}\text{C}$
- Safety class: CLASS II
- Protection grade: IP 68
- Cable range: 2.5MM², 4MM², 6MM², 14AWG, 12AWG, 10AWG
- Tensile strength: $\geq 360\text{N}$

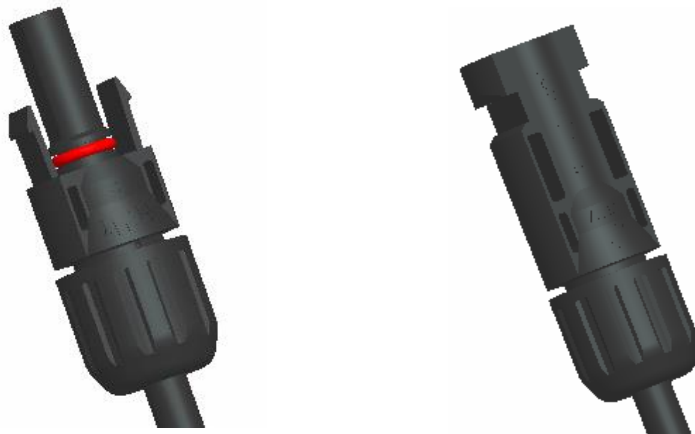
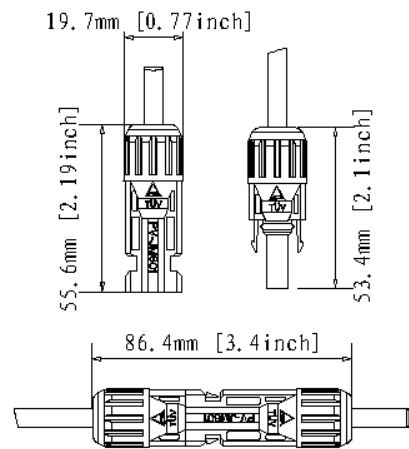

Mail features:

1. Have a strong sense of anti-aging and uv resistant ability;
2. Accord with the use requirement of outdoor environment conditions;
3. A riveting and tight coupling mode is used to connect cable connection;
4. Male female head fixed with stable self-locking mechanism, open and close freely;

Safety instruction:

1. The product shall have corresponding qualifications or through specialist training, to have relevant security applications professional installation of specification. The company does not undertake for any responsibility due to not complying with these warnings.
2. Only can use the company specified parts and tools. For self assembly, be sure to comply with the specified preparation and installation instructions, otherwise, the company shall not guarantee for the safety of products and the regulation of technical parameter. For the product please do not do any form of modification.
3. Those parts matching with the company, not the company from the connector and the manufacturers are sometimes called as "the company's products compatible" connector, they do not conform to the safety, the electrical connection in the long-term, stable, and for security reasons, do not allow their parts connected with the company. If the connector parts connected with the company and produce damage, we do not assume any responsibility.



Here shows the operation is not allowed under the charged or load.



End products must provide electric shock protection (for example: by correct installation plug connector)



In the case of load, the connector is not allowed to disconnect. In the case of charged allow plug.



Water tightness of the product in accordance with the IP protection grade product characteristics. But they are not suitable for long-term use under water. Do not use the plug connector is placed directly on the surface roof.



Not advanced state of plug connector to waterproof dustproof protection, the contaminated male female can't plugged in.



Pin connector can't afford to continuous mechanical drawing, cable should be fixed by the cable tie.



For security reasons, the company is strongly recommended, do not use P V C wire or H07RN - F no tin cable.



Described in the rated voltage for the maximum voltage value, and only suitable for the plug connector. The rated voltage must be according to minimum of maximum rated voltage in components and related evaluation standards, certification can be determined.



This product does not need to use any lubricant.



Please see catalogue of more technical parameters.

symbolic-interpretive

Hazardous voltage warning



The danger zone warning



Helpful hints

Chemical resistance show:

reagent	LEXAN	CYCOLOY	CYCOLAC	NORYL
Hydrocarbon				
Aliphatic series	-/.	.	+	./-
Aromatic series	-	-	-	-
Halogenate, complete	.	.	-	-
Halogenate, portion	-	-	-	-
Alcohols	+	n	+	+
Phenols	-	-	-	-
Ketone	-	-	-	-
Amine	n	-	-/.	-/.
Esters	-/.	-	.	+
Ethers	-	-	.	.
Acid				
Inorganic	-/.	.	+	.
Organic	.	.	-	.
Oxidation	-	-	-	.
Alkali	-	.	+	+
Vehicle use liquid				
Grease (no reactive organic esters)	n	+	+	./+
Oil (unsaturated aliphatic compounds)	n	./-	./+	./+
Wax (heavy oil)	n	+	+	./+
Gasoline	-	-	-	-
Cooling liquid (glycol)	n	.	.	+
Brake oil (rhizome paridis)	n	-	-	+
detergent - detergent	n	./+	./+	./+
water				
hot (< 176° F [80° C])	-/.	./+	-/.	++
Environment				
UV	./+	./+	./+	.

++ Very good: According to the requirements, not as time, temperature and pressure and affect the performance

+ Good: Under normal exposure is characteristic of acceptable wreck, under the long-term exposure can lead to a small amount of the characteristics of the wreck, the characteristics of high temperature could lead to more wreck

. Fair: On the edge of the standard, can only be a short period of time in the low temperature exposure or wreck its mechanical properties are poor, it doesn't matter - can't accept it

n: No test

i Postil: Shows the results of quality comes from the control test, and use for indicative purposes only.
The performance of the finished product must be used in the final environment to do use
components of the method is evaluated.

Installation instruction:

1. Tool request:

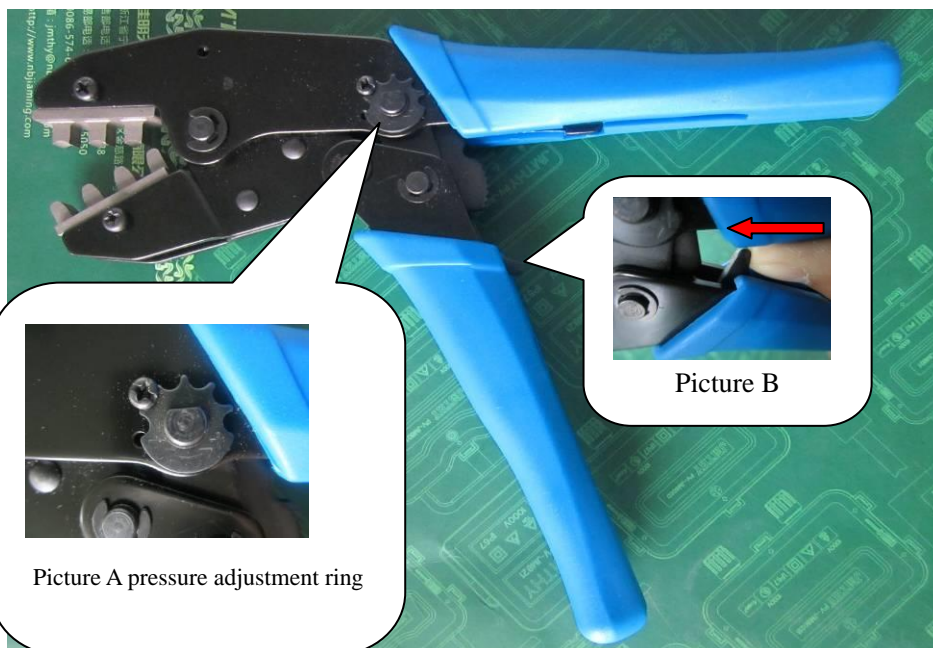
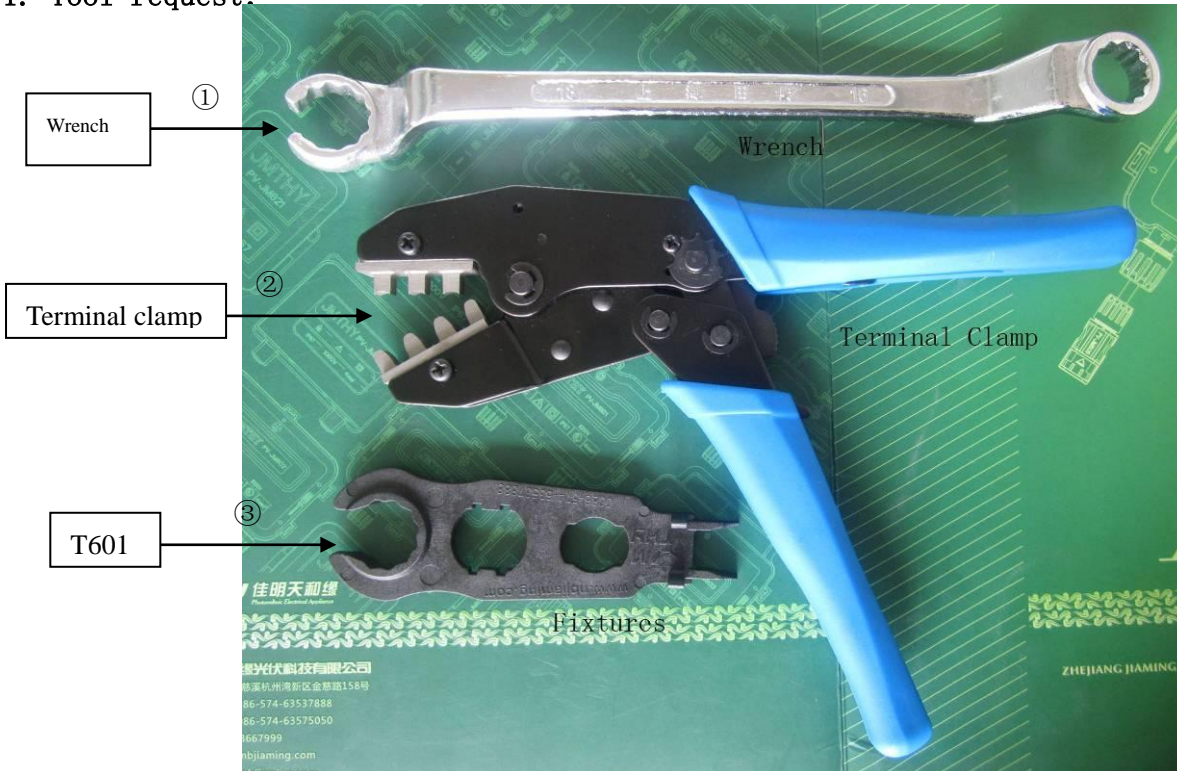

Terminal use instruction:

- (1) Riveting pressure regulation: use "ten" word screwdriver first pressure adjustment ring screw loosening, turn adjusting piece (counterclockwise to increase pressure, on the other hand to reduce) adjust the pressure (see picture A);
- (2) As an assignment to a half need to loosen the terminal riveting clamp, available fingers jacking can loosen the valve on the limit (see picture B) .

Installation instruction:

2. Part instruction:

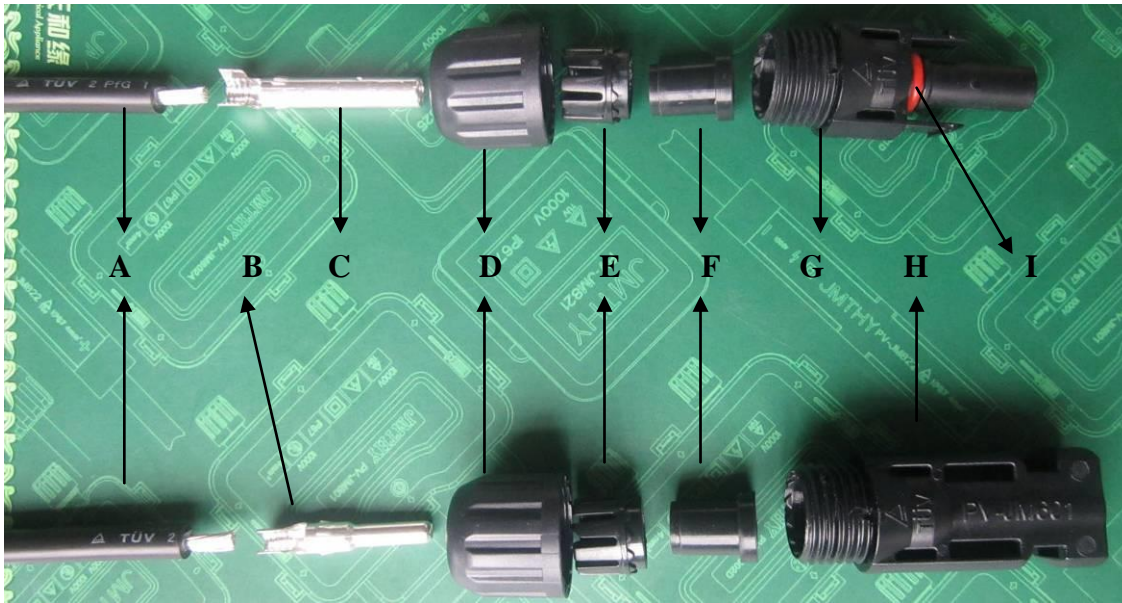

A:cable B:pin C:socket D:nut E:basket F "T" ring G:male H:female I: "O" ring



Instruction: 1、 "T" ring (F) along with the change of cable model change.

2、 Socket (C) Intranet spring silver plating, oxidation resistance and conductive performance is better than that of the European spring of tin net

3. Assembly step:

- (1)Cut cable: The cable according to the required length cut (crack a 9 mm to connect one end of the connector)



Attention:

Please do not use coating or oxidation.



Attention:

Don't peel off when stripping the copper Wire inside.

Installation instruction:

(2) Rivet pin, socket: first will strip away neatly into the pin and plug at the end of the set of "U" shaped groove, reoccupy crimping pliers to riveting.

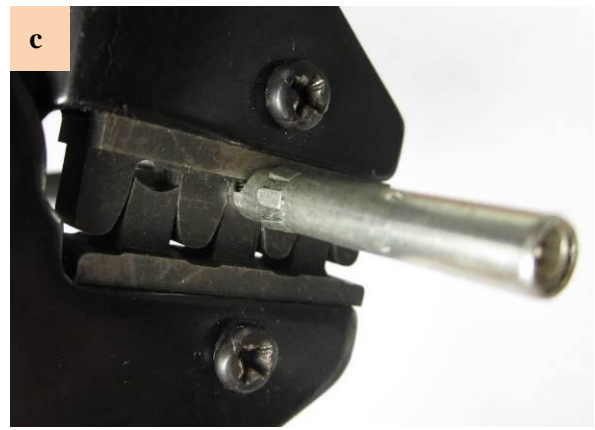
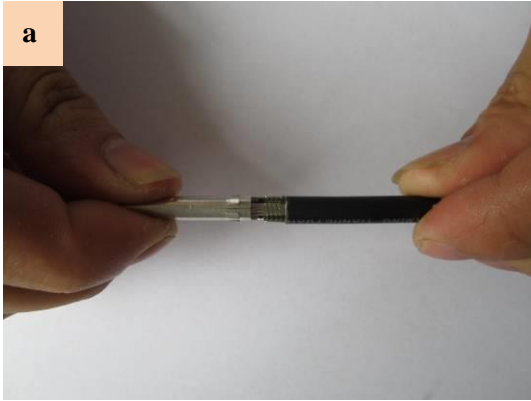

Clamping checking



Tensile test

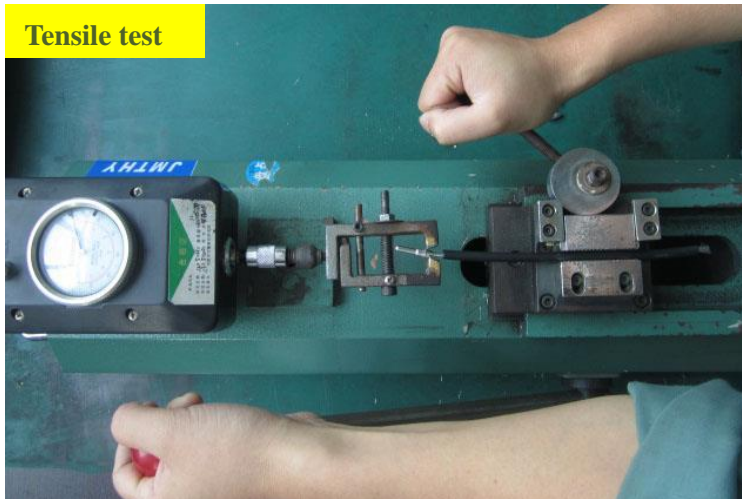

Attention:

Terminal riveting, tensile force should be more than 310N.

Installation instruction:

(3) Plug wire: Insert the cable into the connector (when insert you will heard the sound of the "cut");



(5) Tight nut: First put the connector in T601 spacing hole, then use wrench nut trapping dextral to tighten it.

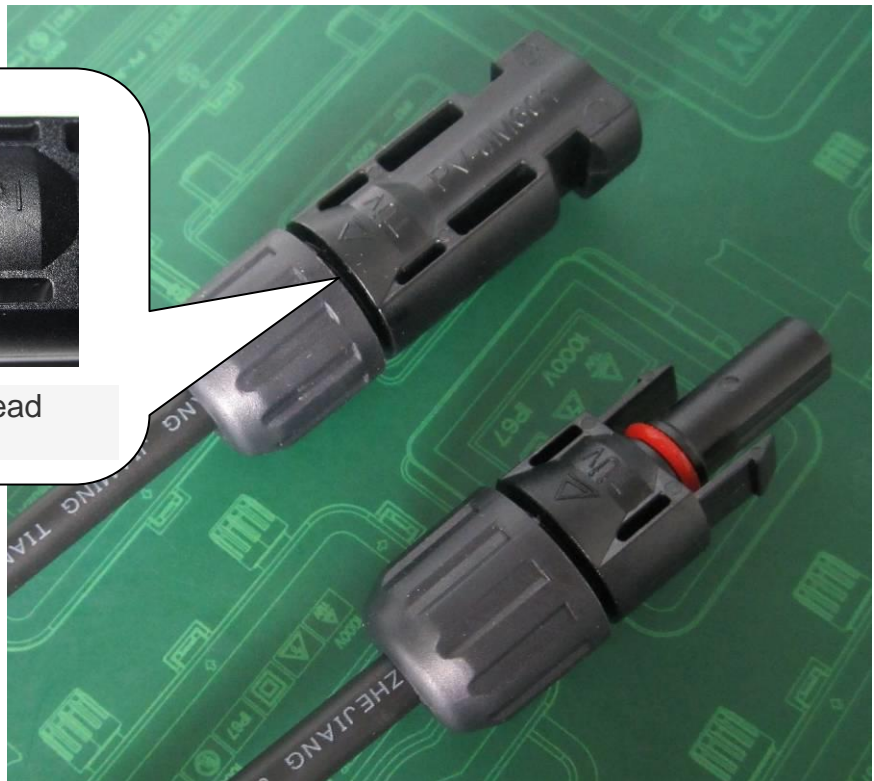
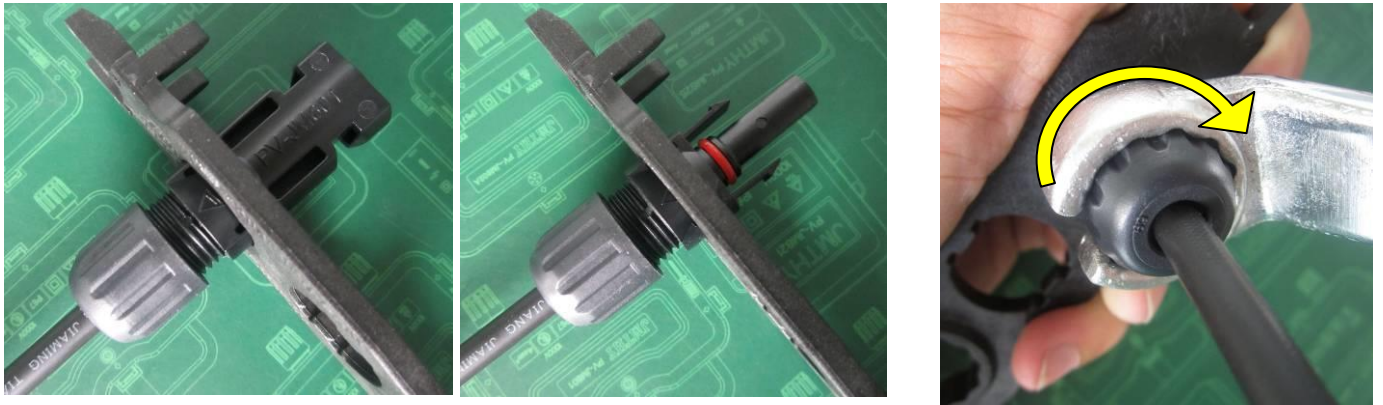

Connector and disconnect instruction:

Insert

Aim the connectors and plugs mother plug installation direction of the arrow insert, tick that put in place. Pull the cable joint check whether the joint is fully connected。

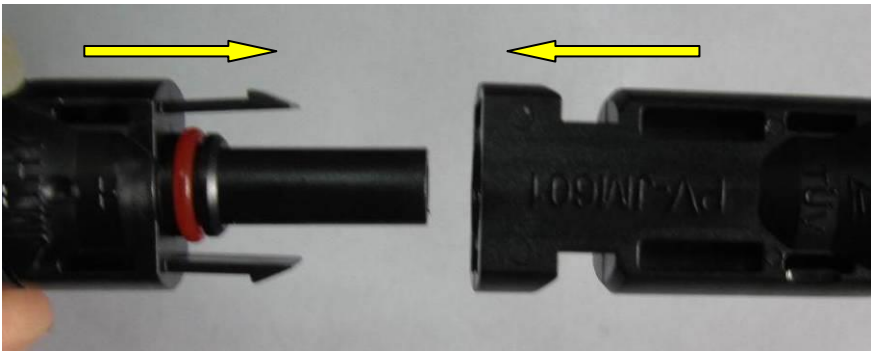

Pull out

Pull out the connector, T601 conformity of lock installed at the same time with the hand pull direction of the arrow, unplug cable connector.

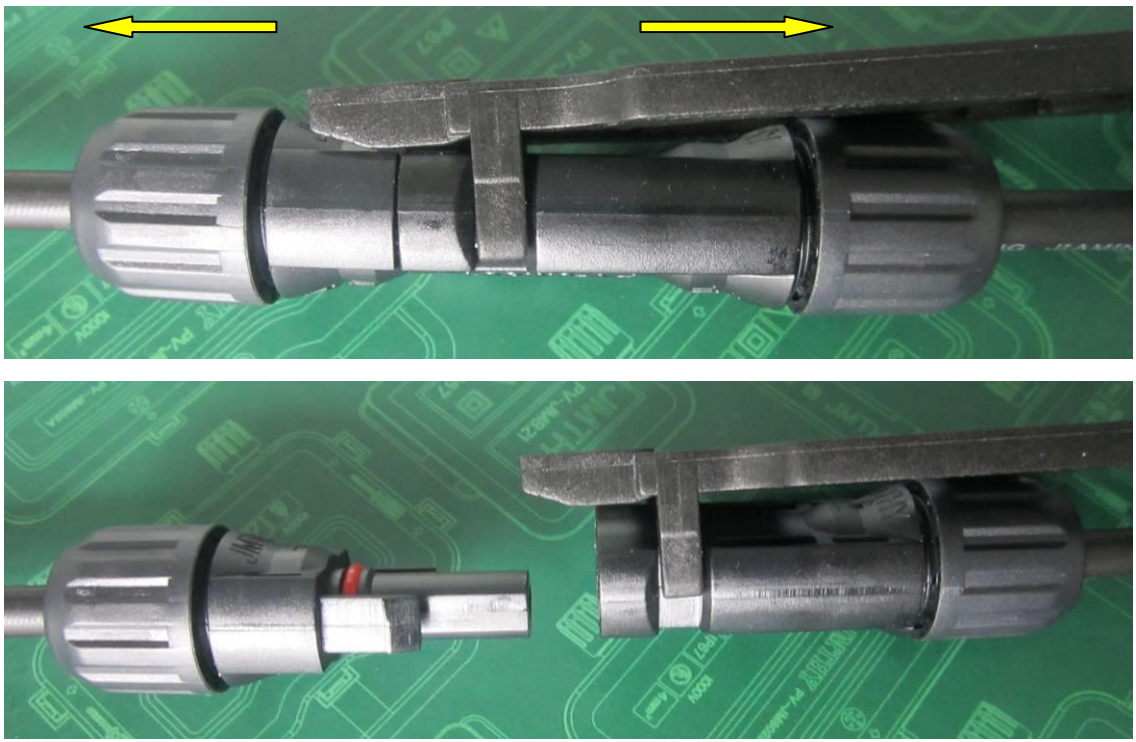

⚠ Cable status:
Efforts can not make the plastic sealing part produces obvious deformation.